

REV/	ECN. NO.	APP	DATE
A	EDIÇÃO INICIAL		
B	NOVO CÓDIGO		

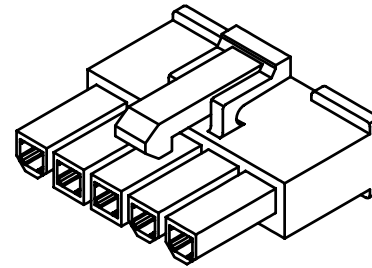

SPECIFICATIONS

Current Rating: 7A AC,DC
Voltage Rating: 250V AC,DC
Temperature Range: -25°C ~ +85°C
Contact Resistance: 10mΩ Max
Insulation Resistance: 1000MΩ Min
Withstanding Voltage: 1500V AC/minute
Material: Nylon 66,UL94V-0 or UL94V-2

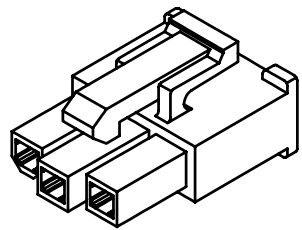
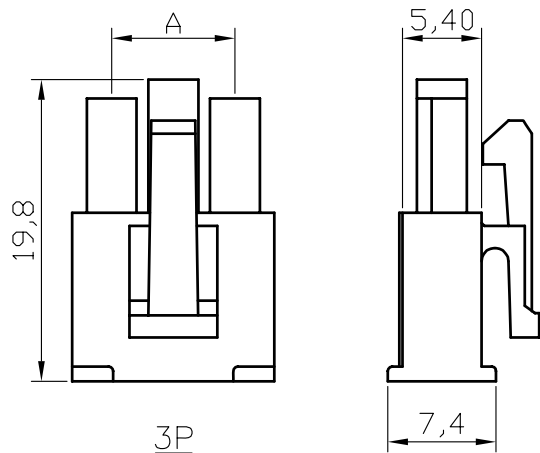

3P

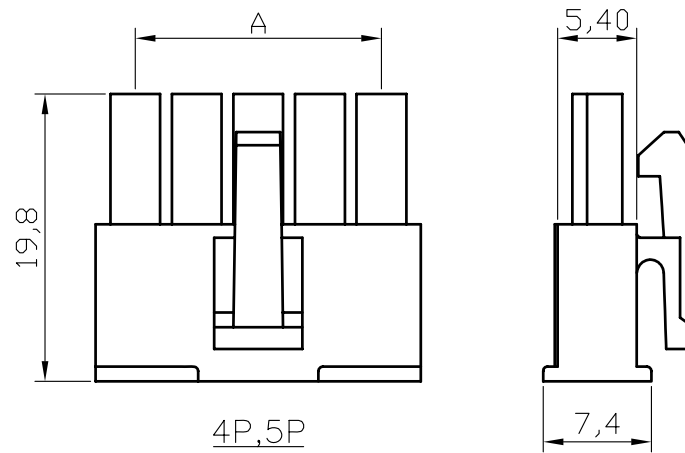

4P,5P

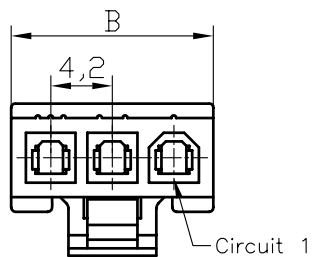

Circuit 1

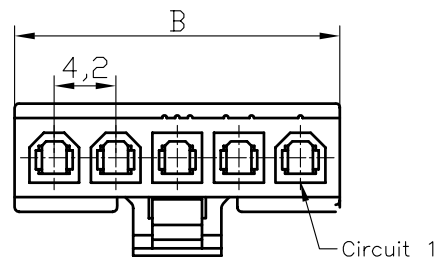

Circuit 1

HOW TO ORDER:

420HSF[][]R

1 2

- 1- N° of Contacts:
3 to 5
- 2- Material:
()-Nylon 66 UL 94V-2
(1)-Nylon 66 UL 94V-0

NO.	Dimensions	
	A	B
03	8.40	13.80
04	12.60	18.00
05	16.80	22.20



MATRIX TECNOLOGIA IND. E COM. LTDA.

UNIT mm	SCALE	TITLE 4,2mm HOUSING FEMALE SINGLE ROW	DATE MARCH 2010
TOLERANCE: ±0.25			APP. BY
		MATL	CHK. BY
		DWG. NO.	DR. BY FELIPE

REV	ECN. NO.	APP	DATE
A	EDIÇÃO INICIAL		
B	NOVO CÓDIGO		

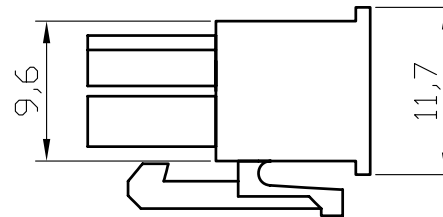
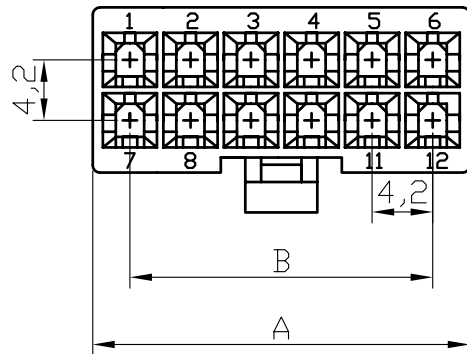
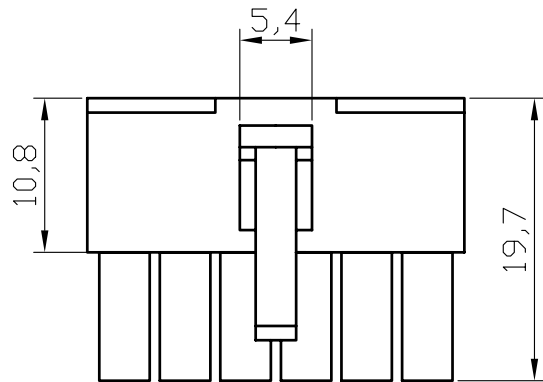

SPECIFICATIONS

Current Rating: 7A AC,DC

Voltage Rating: 250V AC,DC

Temperature Range: -25°C ~ +85°C

Contact Resistance: 10mΩ Max

Insulation Resistance: 1000MΩ Min

Withstanding Voltage: 1500V AC/minute

Material: Nylon 66,UL94V-0 or UL94V-2

HOW TO ORDER:

4200HF[][]R

1 2

1- N° of Contacts:

2 to 24

2- Material:

()-Nylon 66 UL 94V-2

(1)-Nylon 66 UL 94V-0

CIRCUITS	DIMENSION	
	A	B
2	5.5	
4	9.7	4.2
6	13.9	8.4
8	18.1	12.6
10	22.3	16.8
12	26.5	21.0
14	30.7	25.2
16	34.9	29.4
18	39.1	33.6
20	43.3	37.8
22	47.5	42.0
24	51.7	46.2



MATRIX TECNOLOGIA IND. E COM. LTDA.

UNIT mm	SCALE	TITLE	DATE MARCH 2010
TOLERANCE: ±0.25		4,2mm HOUSING FEMALE DUAL ROW	APP. BY
		MATL	CHK. BY
		DWG. NO.	DR. BY FELIPE