

REV	ECN. NO.	APP	DATE
A	EDIÇÃO INICIAL		

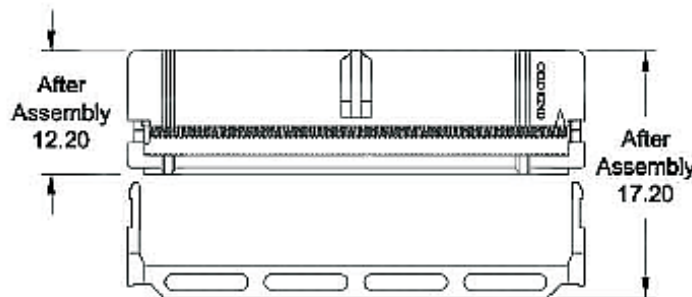
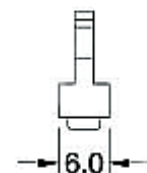
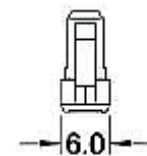
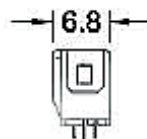
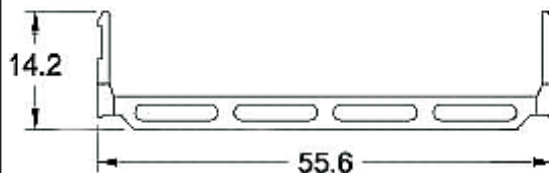
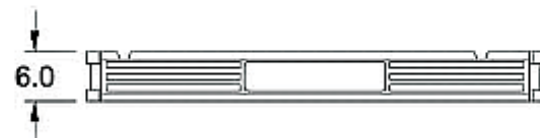
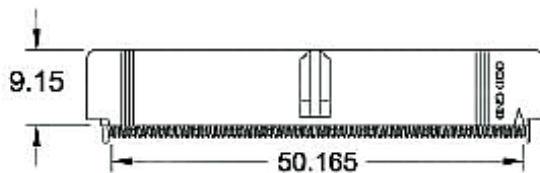
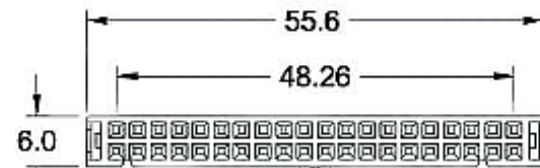

SPECIFICATIONS

Material

Insulator : PBT glass reinforced, rated UL 94V-0

Contact : Phosphor Bronze or Brass

Electrical

Current Rating : 1Amp

Contact Resistance : 30 m ohms max.

Insulation Resistance : 3000 M ohms min.

Dielectric Withstanding Voltage : 500V AC for 1minute

Operating Temperature : -40° ~ +105°

HOW TO ORDER: 4401[][SR][]ATAWBR

1 2 3

1- Nr. of Ways
See Table

2- Function
(SR) With Strain Relief
() Without Strain Relief

3- Terminal Plating
(E)-Sn

(D)-FLASH Au

(F)-0,38um Au

(G)-0,76um Au

(C)-0,38um Au/Sn

(H)-0,76um Au/Sn



MATRIX Tecnologia Ind. e Com. Ltda.

UNIT	SCALE	TITLE	DATE
mm		2.54mm Ultra ATA Bus Connector With Bump	September 2007
TOLERANCE: ±0.25			APP. BY
		MATL	CHK. BY
		DWG. NO.	DR. BY Diego