

REV	ECN. NO.	APP	DATE
A	EDIÇÃO INICIAL		

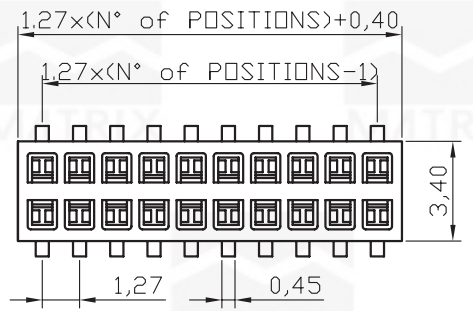
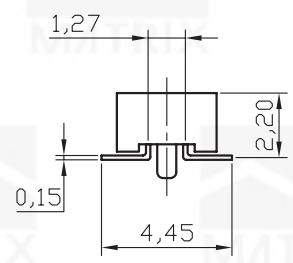
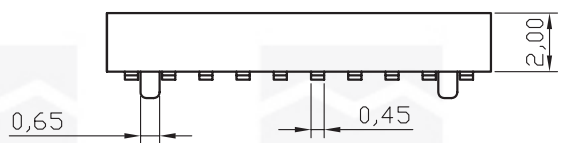

SPECIFICATIONS

Current Rating: 1Amp
 Insulator Resistance: 5000MΩ min.
 Contact Resistance: 20mΩ max.
 Dielectric Withstanding: AC 500V
 Operating Temperature: -40°C to 105°C
 Max Processing Temp: 230°C for 30 seconds
 Contact Material: Phosphor Bronze
 Insulator Material: High Temperature Termoplastic, UL 94V-0
 Finish: Gold Plated
 Standard: Gold flash all over

HOW TO ORDER:
MAT-[] [D] [R] [] B1,27SMD-P2[P]-[]
1 2 3 4 5 6

- 1- Nr. of Ways
Double Row: 2 to 80
- 2- Row Version:
(D)-Double Row
- 3- Pin Style*
(R)-180°
- 4- Terminal Plating:
(E)-Sn
(D)-FLASH Au
(F)-0,38um Au
(G)-0,76um Au
(C)-0,38um Au/Sn
(H)-0,76um Au/Sn
- 5- (P)-W/Locating Peg
()-W/D Locating Peg
- 6- (R)RoHS Compliant

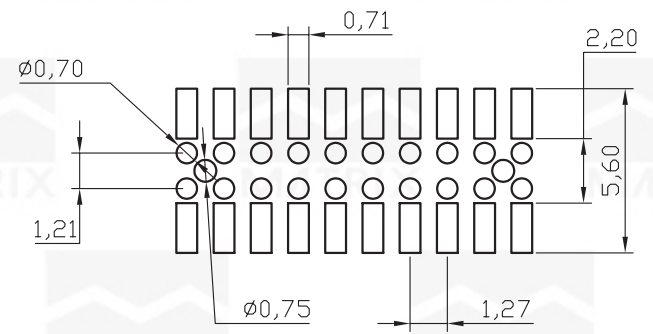

		MATRIX Tecnologia Ind. e Com. Ltda.	
0.0±	SCALE	TITLE	DATE
0.00±		1.27mm FEMALE HEADER	JUNE 2007
0.000±	UNIT mm	HEIGHT 2,0mm BOTTOM ENTRY	APP. BY
		DOUBLE ROW 180° SMT TYPE	
		MATL	CHK. BY
		DWG. NO.	DR. BY DIEGO