

REV/	ECN. NO.	APP	DATE
A	EDIÇÃO INICIAL		

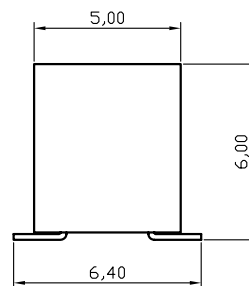
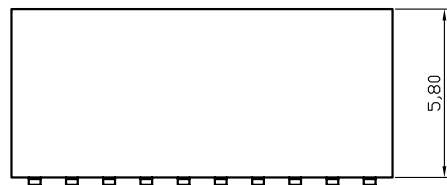

**SPECIFICATIONS**

Currente Rating: 1Amp  
 Insulation Resistance: 1000MΩ Min.  
 Dielectric Withstanding: 300V AC/DC  
 Contact Resistance: 20mΩ Max.  
 Operating Temperature: -40°C to 105°C

**MATERIAL**

Contact Material: Phosphor Bronze  
 Insulation Material: Polyester, UL 94V-0  
 Nylon 6T

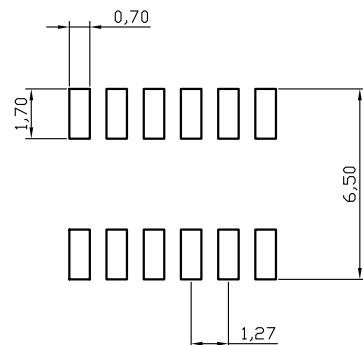
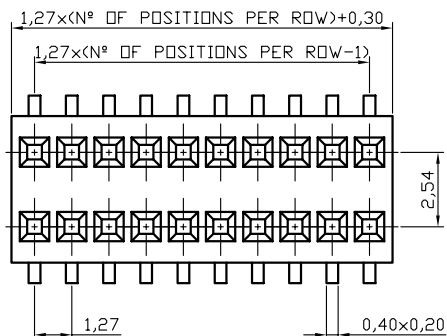

Recommended P.C.Board Hole Layout

**HOW TO ORDER:**  
**MAT-[ ] [D] [R] [ ] S1.27x2.54SMD-P5.8 [ ]**  
**1 2 3 4 5**

- 1- Nr. of Ways  
 Single Row: 1 to 40  
 Double Row: 2 to 80
- 2- Row Version:  
 (S)-Single Row  
 (D)-Double Row
- 3- Pin Style  
 (N)-90°  
 (R)-180°
- 4- Terminal Plating:  
 (E)-Sn  
 (D)-FLASH Au  
 (F)-0,38um Au  
 (G)-0,76um Au  
 (C)-0,38um Au/Sn  
 (H)-0,76um Au/Sn
- 5- (R)RoHS Compliant



**MATRIX Tecnologia Ind. e Com. Ltda.**

0.0±	SCALE	TITLE	DATE JUNE 2007
0.00±	UNIT mm	1.27x2.54mm FEMALE HEADER HEIGHT 5.8mm DOUBLE ROW SMT TYPE	APP. BY
0.000±			
		MATL	CHK. BY
		DWG. NO.	DR. BY DIEGO