

| REV/ | ECN. NO. | APP | DATE |
|------|----------------|-----|------|
| A | EDIÇÃO INICIAL | | |
| | | | |
| | | | |
| | | | |

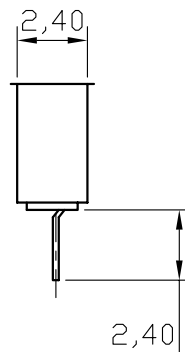

SPECIFICATIONS

Current Rating: 1Amp
 Insulator Resistance: 1000MΩ min.
 Contact Resistance: 20mΩ Max.
 Dielectric Withstanding: AC 500V
 Operating Temperature: -40°C to 105°C
 Contact Material: Phosphor Bronze
 Insulator Material: Polyester, UL94V-0

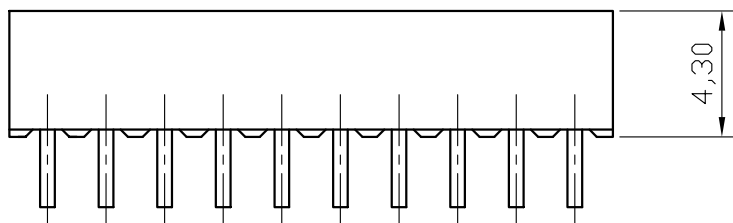
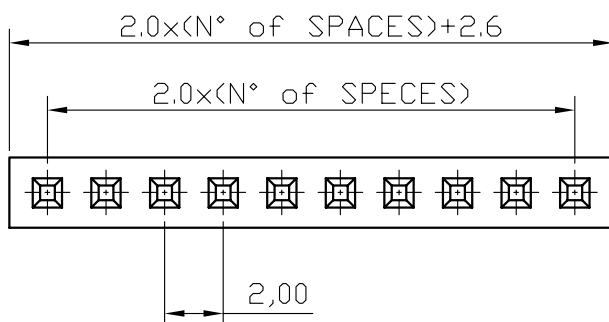

HOW TO ORDER: MAT-[]-[S]-[R]-[]-S-2.0-P4.3-[]

- | | |
|--|--|
| 1- Nr. of Ways Single Row: 1 to 40 Double Row: 2 to 80 | 4- Terminal Plating: (E)-Sn (D)-FLASH Au (F)-0,38um Au (G)-0,76um Au (C)-0,38um Au/Sn (H)-0,76um Au/Sn |
| 2- Row Version: (S)-Single Row (D)-Double Row | 5- (R)RoHS Compliant |
| 3- Pin Style (N)-90° (R)-180° | |

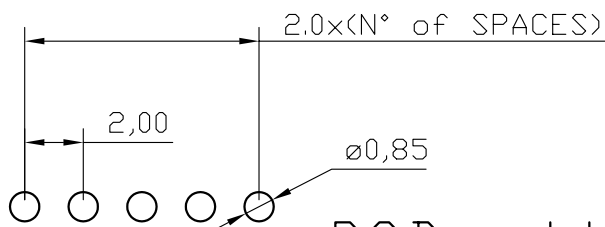

P.C.Board layout
(Dual row)



MATRIX Tecnologia Ind. e Com. Ltda.

| | | | |
|--------|---------|-----------------------------|--------------|
| 0.0± | SCALE | TITLE | DATE |
| 0.00± | UNIT mm | 2.00mm FEMALE HEADER | OCTUBER 2007 |
| 0.000± | | HEIGHT180° 4.6mm SINGLE ROW | APP. BY |
| | | MATL | CHK. BY |
| | | DWG. NO. | DR. BY DIEGO |