

REV	ECN. NO.	APP	DATE
A	EDIÇÃO INICIAL		

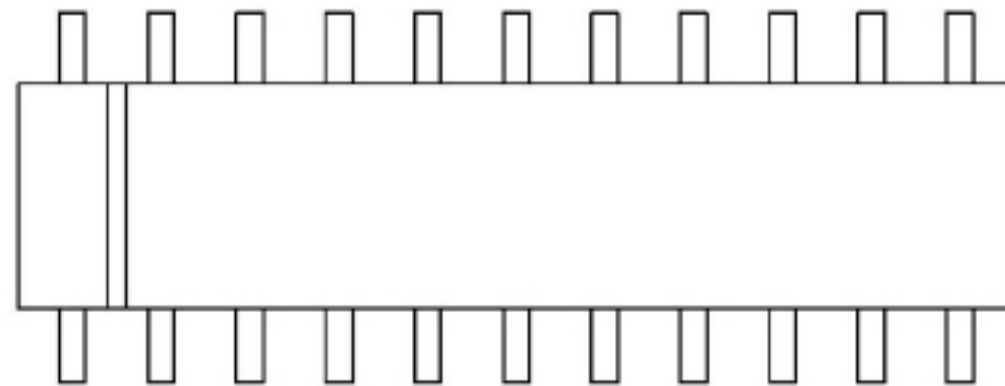

RECOMMENDED P.C.B LAYOUT

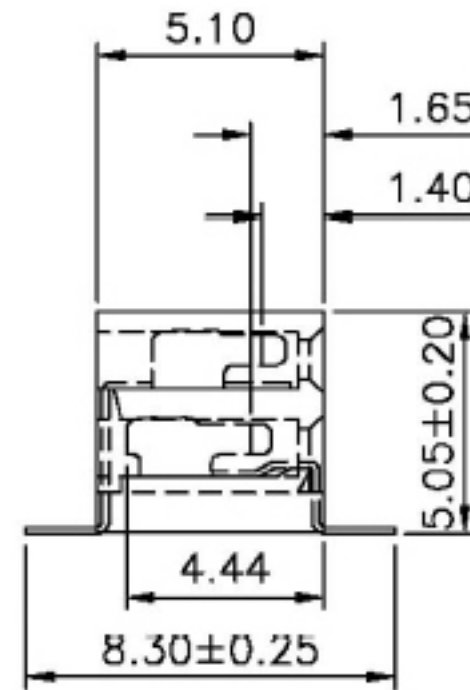
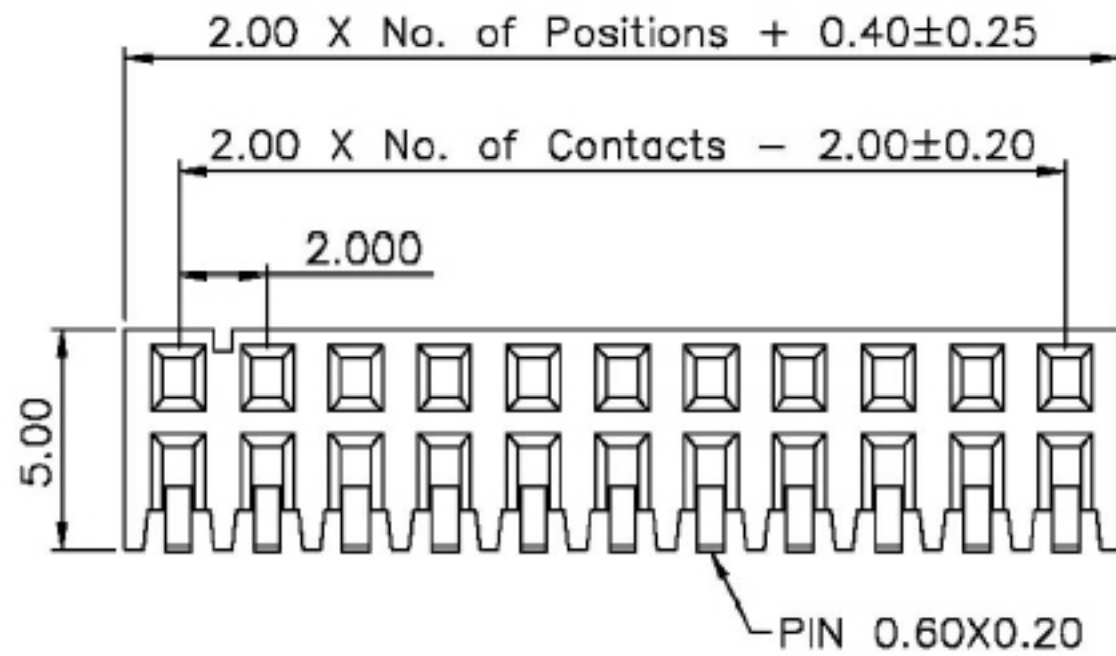
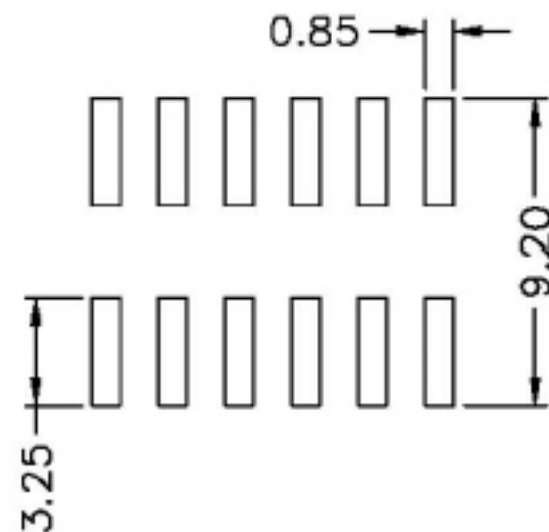

Specifications

Current Rating: 2Amp  
 Insulation Resistance: 1000MΩ Min.  
 Dielectric Withstanding: 500V AC/DC  
 Contact Resistance: 20mΩ Max.  
 Operating Temperature: -40°C to +105°C

Materials

Contact Material: Phosphor Bronze  
 Insulation Material: Polyester, UL 94V-0  
 NYLON-6T

HOW TO ORDER:

**MAT-[ ]-[D]-[R]-[ ]-S-2.0-SMD-P4,9-[ ]**  
 1 2 3 4 5

- 1- Nr. of Ways  
Double Row: 2 to 80
- 2- Row Version:  
(D)-Double Row
- 3- Pin Style  
(R)-180°
- 4- Terminal Plating:  
(E)-Sn  
(D)-FLASH Au  
(F)-0,38um Au  
(G)-0,76um Au  
(C)-0,38um Au/Sn  
(H)-0,76um Au/Sn
- 5- (R) RoHS Compliant

		MATRIX TECNOLOGIA IND. E COM. LTDA.	
UNIT mm	SCALE	TITLE 2.0mm FEMALE HEADER HEIGHT 4.9mm DOUBLE ROW SMD TYPE	DATE SEPTEMBER 2007
TOLERANCE: ±0.25			APP. BY
		MATL	CHK. BY
		DWG. NO.	DR. BY DIEGO