

REV	ECN. NO.	APP	DATE
A	EDIÇÃO INICIAL		

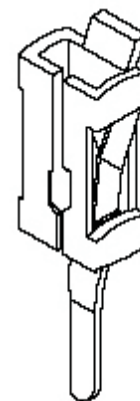
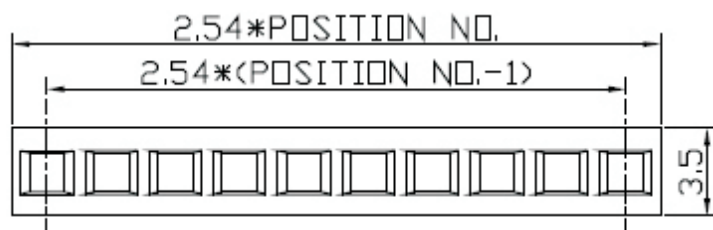
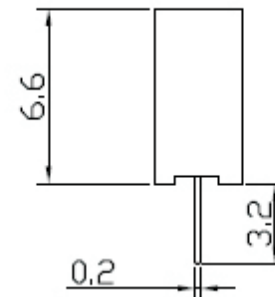
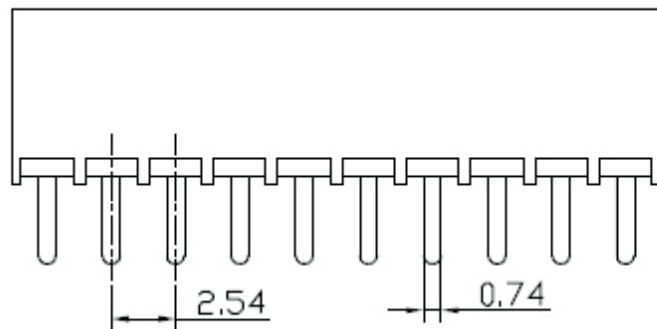

SPECIFICATIONS

CURRENT RATING
1 AMP DC

CONTACT RESISTANCE
30 MILLIOHM MAX

INSULATION RESISTANCE
3000 MEGOHM MIN

DIELECTRIC VOLTAGE
500V AC FOR ONE MINUTE

OPERATING TEMPERATURE
-40°C TO 105°C

HOW TO ORDER:
MAT-[]-[S]-[R]-[]-S-P6.6-[]
1 2 3 4 5

- 1- Nr. of Ways
Single Row 1 to 40
Double Row: 2 to 80
- 2- Row Version:
(S)-Single Row
(D)-Double Row
- 3- Pin Style
(N)-90°
(R)-180°
- 4- Terminal Plating:
(E)-Sn
(D)-FLASH Au
(F)-0,38um Au
(G)-0,76um Au
(C)-0,38um Au/Sn
(H)-0,76um Au/Sn
- 5- (R) RoHS Compliant

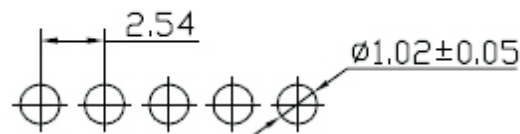

PC BOARD LAYOUT

		MATRIX Tecnologia Ind. e Com. Ltda.	
UNIT mm	SCALE	TITLE 2.54mm FEMALE HEADER H=6.6mm SINGLE ROW 180°	DATE September 2007
TOLERANCE: ±0.25			APP. BY
		MATL	CHK. BY
		DWG. NO.	DR. BY Diego

REV	ECN. NO.	APP	DATE
A	EDIÇÃO INICIAL		

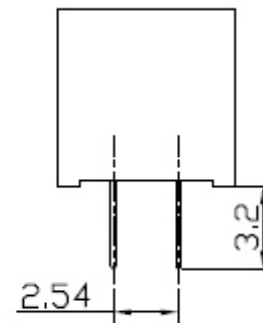
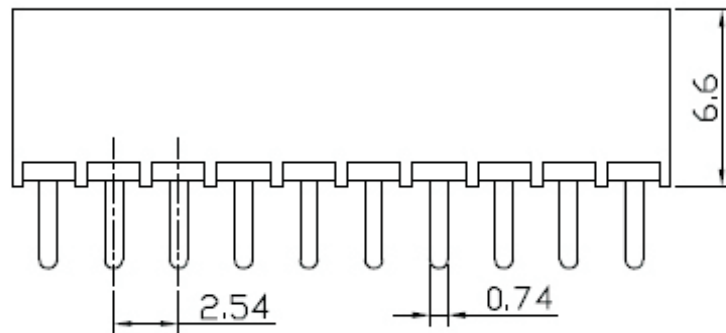

SPECIFICATIONS

CURRENT RATING

1 AMP DC

CONTACT RESISTANCE

30 MILLIOHM MAX

INSULATION RESISTANCE

3000 MEGOHM MIN

DIELECTRIC VOLTAGE

500V AC FOR ONE MINUTE

OPERATING TEMPERATURE

-40°C TO 105°C

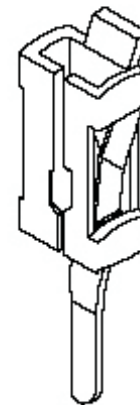
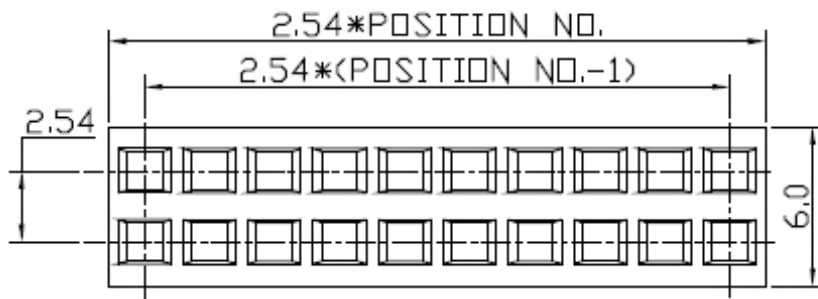

HOW TO ORDER: MAT-[]-[D]-[R]-[]-S-P6.6-[]

1 2 3 4 5

- | | |
|---------------------|-----------------------|
| 1- Nr. of Ways | 4- Terminal Plating: |
| Single Row 1 to 40 | (E)-Sn |
| Double Row: 2 to 80 | (D)-FLASH Au |
| 2- Row Version: | (F)-0,38um Au |
| (S)-Single Row | (G)-0,76um Au |
| (D)-Double Row | (C)-0,38um Au/Sn |
| 3- Pin Style | (H)-0,76um Au/Sn |
| (N)-90° | 5- (R) RoHS Compliant |
| (R)-180° | |

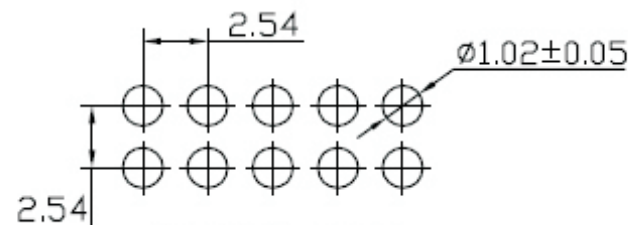

PC BOARD LAYOUT

UNIT		SCALE	TITLE	DATE
mm			2.54mm FEMALE HEADER H=6.6mm DUAL ROW 180°	September 2007
TOLERANCE: ±0.25				APP. BY
		MATL		CHK. BY
		DWG. NO.		DR. BY Diego