

REV/	ECN. NO.	APP	DATE
A	EDIÇÃO INICIAL		

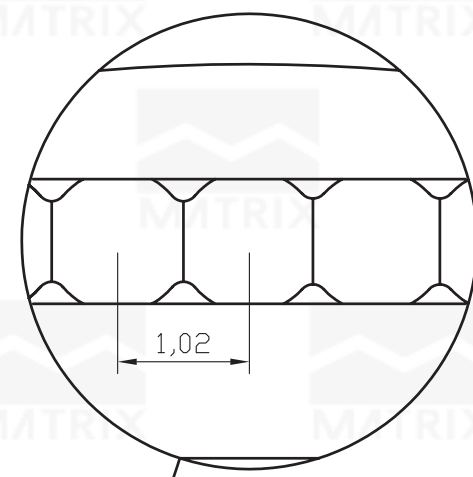
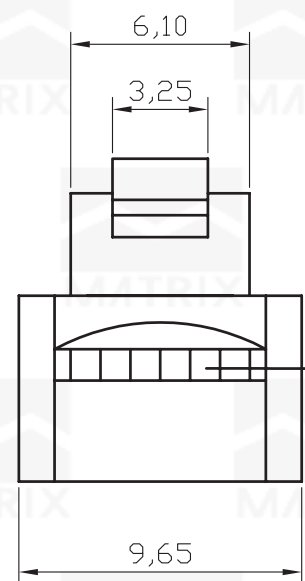
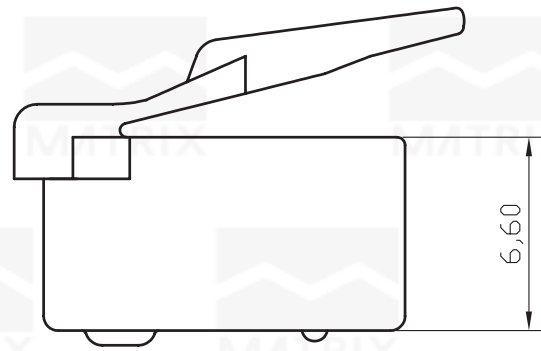
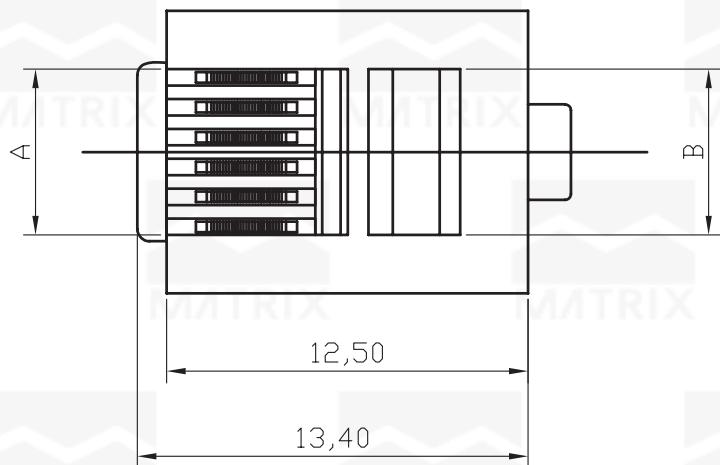

	A	B
6P2C	5,20	5,10
6P4C	5,20	5,10
6P6C	7,10	6,20

HOW TO ORDER:
MX-MP-[]-[]-[]-[]-[]
1 2 3 4 5

- 1- Contact Nr.
 4P2C
 4P4C
 6P2C
 6P4C
 6P6P
 8P8C
 10P10C
- 2- Contact Type
 (R)- for Round Cable
 (F)- for Flat Cable
- 3- Body Option
 (Y) With Shield
 (N) W/O Shield
- 4- Contact Plating
 (3)- 3μ"
 (6)- 6μ"
 (15)- 15μ"
 (30)- 30μ"
 (50)- 50μ"
- 5- (R)-RoHS Compliant



MATRIX **MATRIX TECNOLOGIA IND. E COM. LTDA.**

UNIT mm	SCALE	TITLE	DATE OCTOBER 2007
TOLERANCE: ±0.25		Modular Plug	APP. BY
		MATL	CHK. BY
DWG. NO.		DR. BY DIEGO	