

REV	ECN. NO.	APP	DATE
A	EDIÇÃO INICIAL		

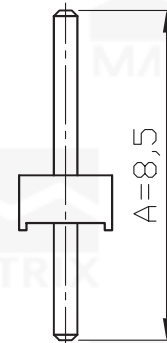
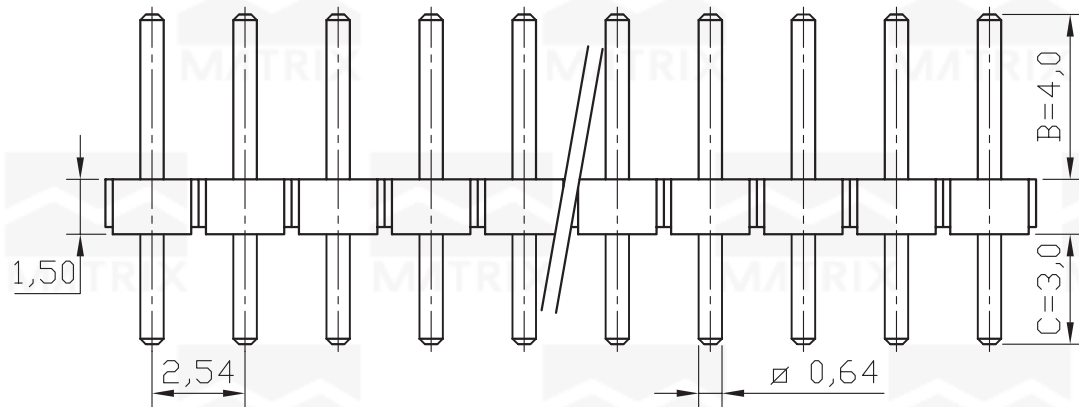

**SPECIFICATION**

Current: 3A  
 Operating Temperature: -55°C to 105°C  
 Contact Resistance: 20 MilliΩHMS Max.  
 Insulator Resistance: 1000MegaΩHMS Min.  
 Withstanding Voltage: AC 1000V RMS

**MATERIAL**  
 Housing: Thermoplastic UL94V-0  
 Contact: Copper Alloys

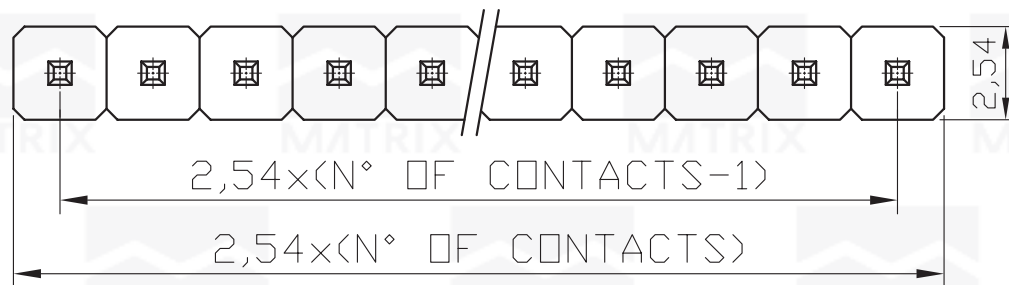

**HOW TO ORDER:  
 PIN-[ ]-[S]-[R]-[ ]-S-P1,5[ ]**

**1 2 3 4 5**

- 1- Nr. of Ways  
Single Row: 2 to 40
- 2- Row Version:  
(S)-Single Row
- 3- Pin Style  
(N)-90°  
(R)-180°
- 4- Terminal Plating:  
(E)-Sn  
(F)-FLASH Au  
(A)-0,38um Au  
(B)-0,76um Au  
(C)-0,38um Au/Sn  
(D)-0,76um Au/Sn
- 5- (R) RoHS Compliant



**MATRIX Tecnologia Ind. e Com. Ltda.**

UNIT mm	SCALE 5:1	TITLE 2,54mm PIN HEADER HEIGHT 1,5mm 180° SINGLE ROW	DATE JULY 2007
TOLERANCE: ±0.25			APP. BY
		MATL	CHK. BY
		DWG. NO.	DR. BY DINO