

REV	ECN. NO.	APP	DATE
A	EDIÇÃO INICIAL		
B	NOVO CÓDIGO		

**SPECIFICATIONS**

Insulator Material: PPS (UL 94V-0)  
 Contact Resistance: 30MΩ MAX at DC 100MA  
 Insulator Resistance: 1000MΩ Min. at DC 500V  
 Current Rating: 1Amp  
 Dielectric Withstanding Voltage: AC 500V for 1 minute  
 Temperature Rating: -55°C to 105°C

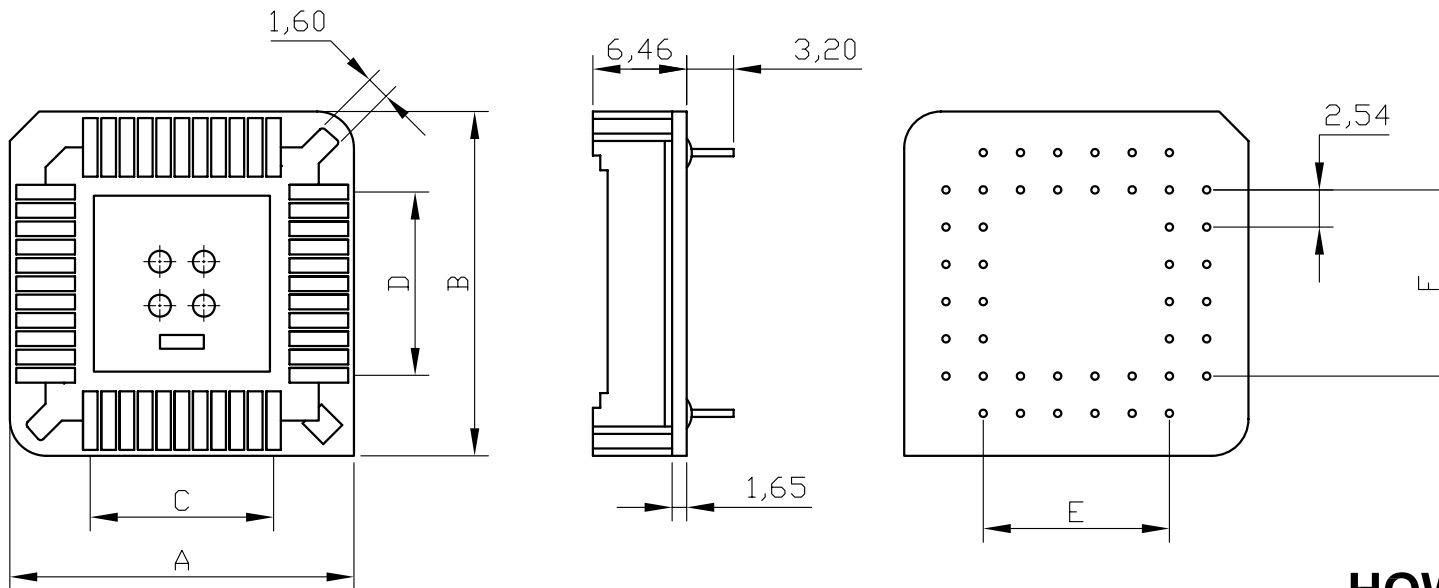

**HOW TO ORDER:  
 PLCC[ ][ ]R  
 1 2**

1- Nr. of Ways  
 (20, 28, 32, 44, 52, 68, 84)  
 2- Insulator:  
 (HT)-High Temperature  
 (P) -Standard

N° of Ways	A	B	C	D	E	F
20	15,50	15,50	5,08	5,08	5,08	5,08
28	18,04	18,04	7,62	7,62	7,62	7,62
32	18,04	20,54	7,62	10,16	7,62	10,16
44	23,48	23,48	12,70	12,70	12,70	12,70
52	25,88	25,88	15,24	15,24	15,24	15,24
68	31,04	31,04	20,32	20,32	20,32	20,32
84	36,04	36,04	25,40	25,40	25,40	25,40

Tolerance: ±0,25



**MATRIX Tecnologia Ind. e Com. Ltda.**

0.0±	SCALE	TITLE PLCC Socket 2.54mm Dip Type	DATE	DECEMBER 2009
0.00±			APP. BY	
0.000±			UNIT mm	
	MATL		CHK. BY	
	DWG. NO.		DR. BY FELIPE	